

产品型号

AU1253L
AU1253S

开 置 式

实物图片

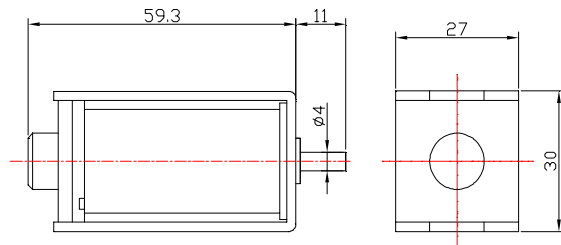
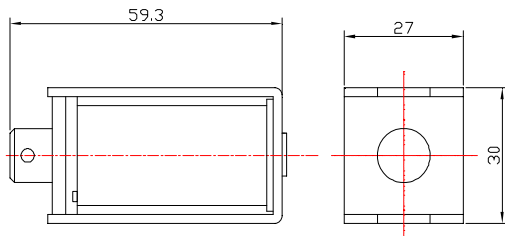
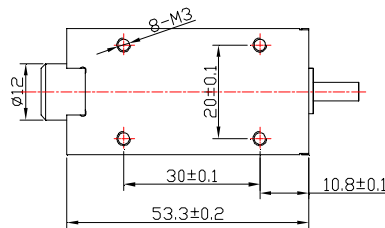
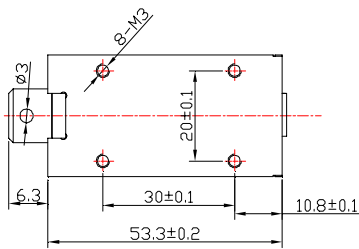
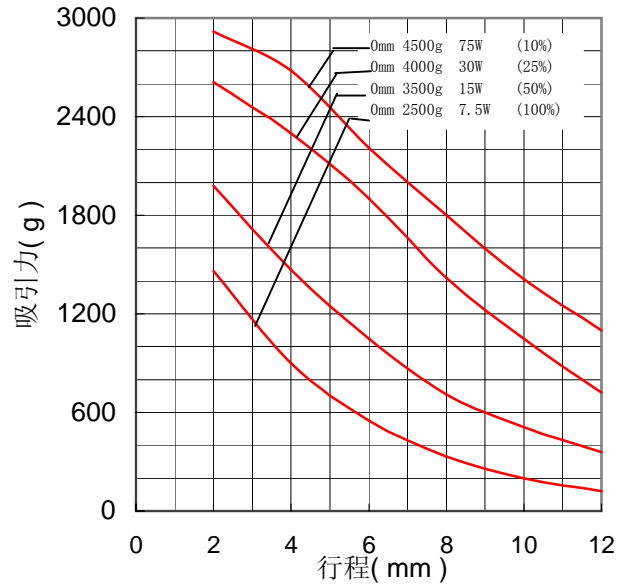

产品参数

| 动作周期 $\frac{\text{ON时间}}{\text{ON时间}+\text{OFF时间}} \times 100\%$ | 100% | 50% | 25% | 10% | |
|--|----------------|----------|------|------|-----|
| | 连续 | 间歇 | | | |
| 最大ON时间(秒) | ∞ | 140 | 50 | 9 | |
| 20°C时功率(W) | 7.5 | 15 | 30 | 75 | |
| 20°C时安匝数 | 1200 | 1700 | 2400 | 3800 | |
| 型号 | 电阻(Ω) | 电压(DC V) | | | |
| AU1253L(S)-06 | 8.4 | 6 | 8.5 | 12 | 19 |
| AU1253L(S)-12 | 19.2 | 12 | 17 | 24 | 38 |
| AU1253L(S)-24 | 76.8 | 24 | 34 | 48 | 76 |
| AU1253L(S)-48 | 307.2 | 48 | 68 | 96 | 152 |